

PAK 200i

MANUAL PLASMA CUTTING AND GOUGING SYSTEMS AND ACCESSORIES

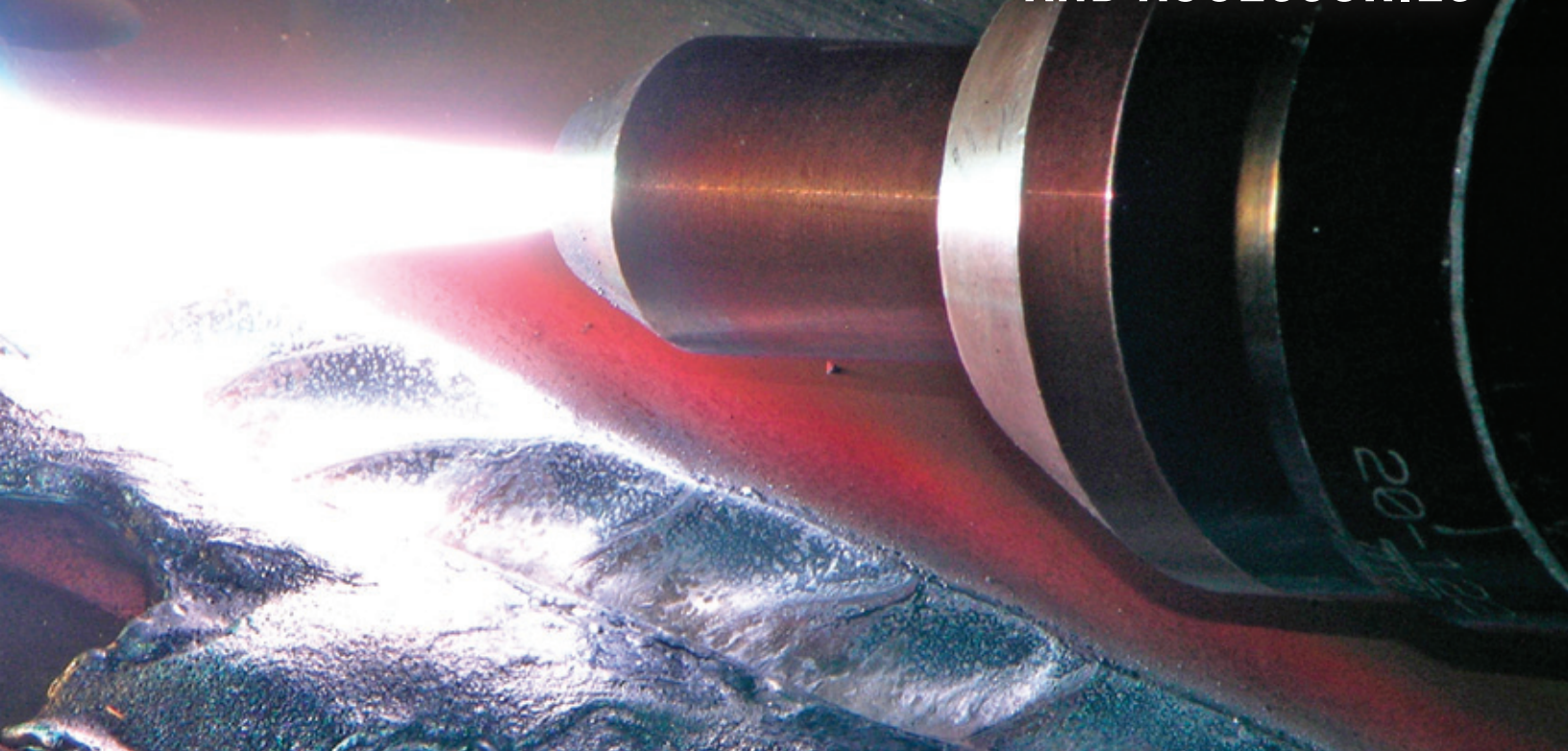

200 Amps of Cutting Power

This unit is capable of hand cutting at 200 Amps with the ability to cut up to 2 3/4" (70 mm) on Mild Steel. At full output this unit will cut 10 ipm (254 mm/min) on 2" (51 mm) carbon steel.

100% Duty Cycle

This machine offers 100% duty cycle at full output.

Dual Gas Capability

The dual gas system ensures superior quality and performance on ferrous and non-ferrous materials. (Plasma Gas: Air, ArH₂ Secondary Gas: Air, N₂)

High Gouging Removal Rate

With the ability to remove up to 25 lbs (11.3 kg) of carbon steel per hour.

Tip Saver for Optimal Tip Life

This ensures that any accidental contact between the tip and the work at high power levels will not damage the tip.



PAK[®] 200i

Manual Plasma Cutting and Gouging Systems and Accessories

Plasma Arc Gouging (PAG)

Plasma Arc Gouging is fast, economical and an environmentally friendly method for removing metal. When compared with Conventional Air Carbon Arc gouging (CAC-A), Plasma Arc Gouging offers:

- Simple Operation
- Easy Acceptance from Operators
- Clear Visibility of Gouging Area
- High Material Removal Rates
- Reduced Smoke in Workplace
- Reduced Noise for Operator and Other Personnel in Surrounding Area
- Cutting Capability of up to 2 3/4" (70 mm) with a Consumable Parts change

PERFORMANCE

- Output Current - 35-200 Amps
- Output Power - 40 kW
- Recommended Cut - 1 1/2" (40 mm)
- Max Cut - 2 3/4" (70 mm)
- Pierce Rating - 1 1/4" (32 mm)

DIMENSIONS

- 48" H x 27.5" W x 40.6" D (1219 x 698 x 1031 mm)

WEIGHT

- 490 lbs w/o torch (222 kg) Fully Assembled Power Supply

INPUT VOLTS

- 380-415V, 3 ph, 50/60 Hz
- 400V CE, 3 ph, 50/60 Hz
- 480V, 3 ph, 50/60 Hz

Contact Victor Technologies™ for additional information on 240V & 600V input voltage requirements.

Torch Consumable Parts

Description	Part No.	Description	Part No.
SHIELD CUPS			
Shield Cup, Standard	32-1325	GAS DISTRIBUTORS	
Crown Shield Cup (Manual Cutting)	32-1326	Gas Distributor, Cutting	32-1315
Shield Cup (Gouging)	32-1527	Gas Distributor, Gouging	32-1509
TIPS			
Tip, 200A	32-1323	ELECTRODES	
Tip, 150A	32-1330	Electrode, Air Cutting	32-1310
Tip, 70A	32-1321	Electrode, Multi-Gas Cutting	32-1311
Tip, 55A	32-1322	Electrode, Air, Gouging	32-1504
Tip, 35A	32-1320	Electrode, ArH ₂ , Gouging	32-1505
Tip (0.110) Gouging	32-1512	OTHER	
Tip (0.125) Gouging	32-1513	Coolant Tube Extension, Gouging	32-1502
Tip (0.156) Gouging	32-1514	Wrench	20-0001
Tip (0.171) Gouging	32-1515	O-Ring Lubricant	8-4025
		Parts Box	9-4173

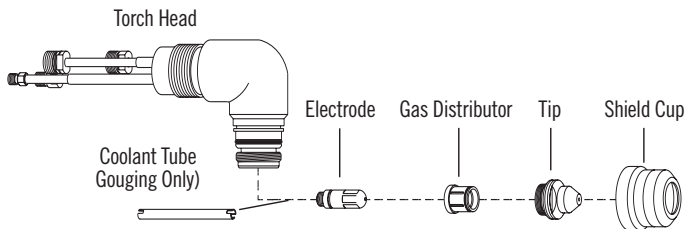

APPLICATIONS INCLUDE:

- General Fabrication of Carbon Steel, Stainless Steel and Aluminum
- Over the Road Transport Trailers
- Railroad Maintenance
- Vessel Manufacturing
- Pipe Beveling & Fabrication
- Petroleum Refineries
- Foundries
- Chemical Plants
- Mining Operations
- Ship Building



Power Supply & Leads

Product Description	Part No.	480V	400V	400V CE
POWER SUPPLY & LEADS				
PAK 200i - 70° Torch / 25' (7.6 m) Leads	1-2239	1-2245	1-2251	
PAK 200i - 70° Torch / 50' (15.2 m) Leads	1-2240	1-2246	1-2252	
PAK 200i - 90° Torch / 25' (7.6 m) Leads	1-2241	1-2247	1-2253	
PAK 200i - 90° Torch / 50' (15.2 m) Leads	1-2242	1-2248	1-2254	
PAK 200i - 180° Torch / 25' (7.6 m) Leads	1-2243	1-2249	1-2255	
PAK 200i - 180° Torch / 50' (15.2 m) Leads	1-2244	1-2250	1-2256	

All manual systems include Power Supply, Torch and Leads, Spare Parts Kit, 25' (7.6 m) Work Cable & Clamp, and Torch Coolant.

Torch & Leads Packages

Description	Part No.
PCH-200 / 70° / 25' (7.6 m) Leads	2-0009
PCH-200 / 70° / 50' (15.2 m) Leads	2-0010
PCH-200 / 70° / 100' (30.5 m) Leads	2-0011
PCH-200 / 90° / 25' (7.6 m) Leads	2-0012
PCH-200 / 90° / 50' (15.2 m) Leads	2-0013
PCH-200 / 90° / 100' (15.2 m) Leads	2-0014
PCM-200 / 180° / 25' (7.6 m) Leads	2-0015
PCM-200 / 180° / 50' (15.2 m) Leads	2-0016
PCM-200 / 180° / 100' (30.5 m) Leads	2-0017

Accessories / Options

Description	Part No.
Torch Guide / Circle Cutting Attachment	7-7505
Remote Pendant Control	7-3460
Wheel Kit	9-7378

